

# 轻型系列回转支承(F口)--无齿式

Light Type Slewing Bearing (Flange Form F) --Without gear type

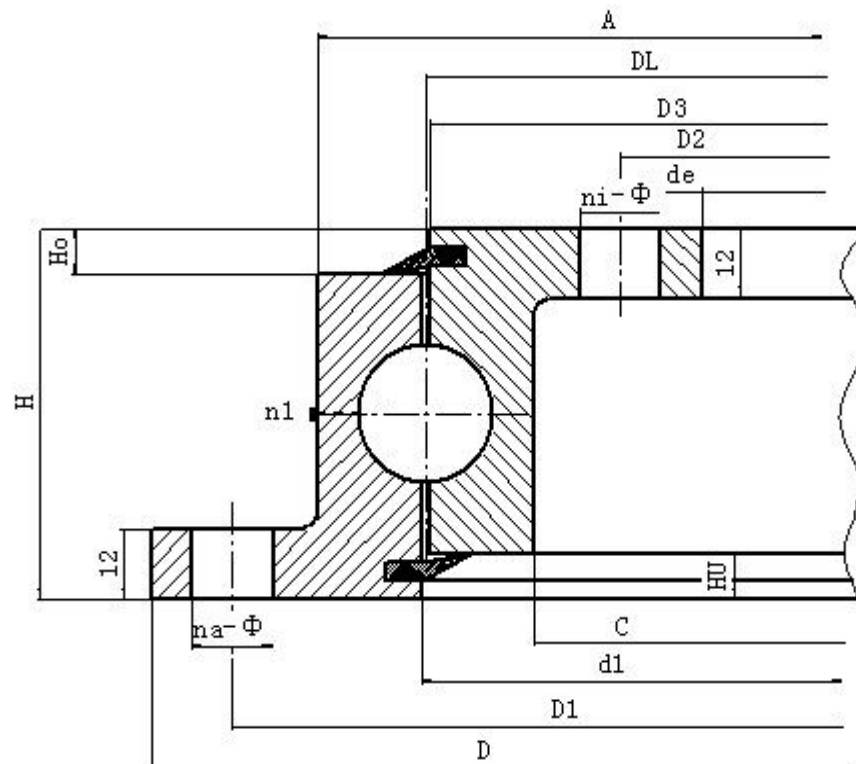

HF-230

型号Model	重量 weight	外形尺寸 Boundary dimension			安装尺寸Mounting Dimensions								结构尺寸Structure dimension						轴承间隙 Bearing clearance	
		D	De	H	D1	D2	na	Φ/M	ni	Φ/M	T	n1	D3	d1	A	C	Hu	Ho	轴向 axial direction	径向 radial direction
		[mm]	[mm]	[mm]	[mm]	[mm]		[mm]		[mm]	[mm]		[mm]	[mm]	[mm]	[mm]	[mm]	[mm]		
HF-230.20.0414	23	518	304	56	490	332	16	18	24	18		4	412.5	415.5	453	375	10.5	10.5	≤0.5	≤0.5
HF-230.20.0544	30.4	648	434	56	620	462	20	18	28	18		4	542.5	545.5	583	505	10.5	10.5	≤0.5	≤0.5
HF-230.20.0644	35.8	748	534	56	720	562	24	18	32	18		4	642.5	645.5	683	605	10.5	10.5	≤0.5	≤0.5
HF-230.20.0744	42.2	848	634	56	820	662	24	18	32	18		4	742.5	745.5	783	705	10.5	10.5	≤0.5	≤0.5
HF-230.20.0844	47.1	948	734	56	920	762	28	18	36	18		4	842.5	845.5	883	805	10.5	10.5	≤0.5	≤0.5
HF-230.20.0944	52.3	1048	834	56	1020	862	32	18	40	18		4	942.5	945.5	983	905	10.5	10.5	≤0.5	≤0.5
HF-230.20.1094	61.1	1198	984	56	1170	1012	32	18	40	18		4	1092.5	1095.5	1133	1055	10.5	10.5	≤0.5	≤0.5